

# Tylersville Road Preliminary Engineering

## West Chester Township, OH

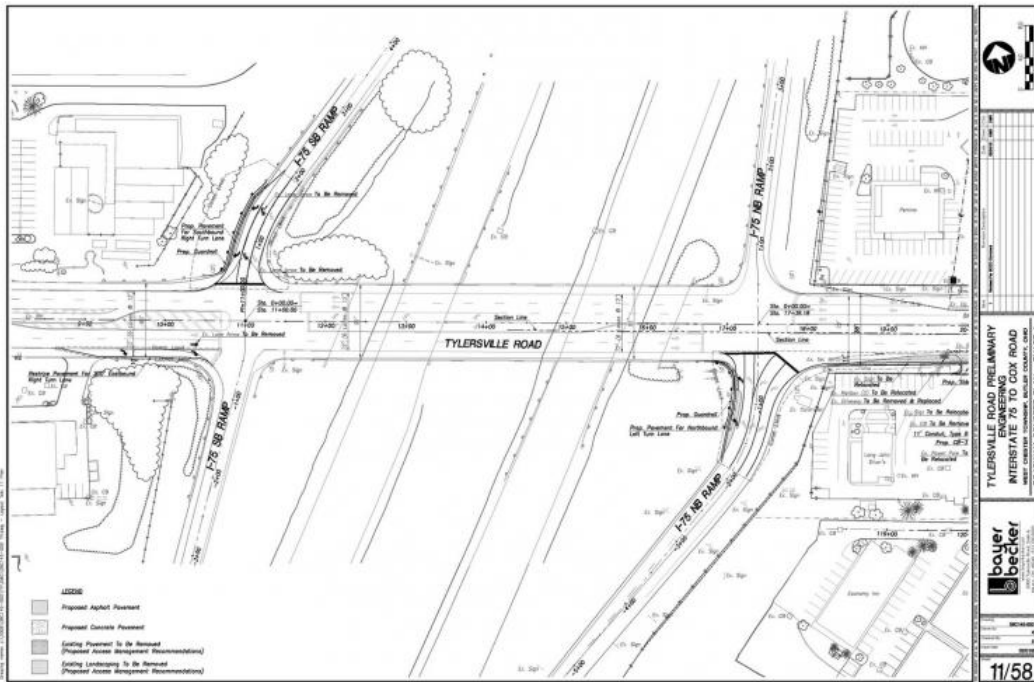

### Project Stats

<b>Client:</b>	Butler County Engineer's Office
<b>Location:</b>	West Chester Township, OH
<b>Year:</b>	2009
<b>Market:</b>	<a href="#">Traffic Infrastructure</a>
<b>Project Size:</b>	2.00 Lane Miles

### Services Provided:

#### SURVEYING SERVICES

Right-of-way Surveys & Drawings

#### TRANSPORTATION ENGINEERING SERVICES

Access Management Plans  
 Signing & Striping Plans  
 Traffic Counts



When Butler County wanted to analyze the traffic problems along the Tylersville Road corridor to determine the most economically viable design to alleviate access management issues and congestion, they selected Bayer Becker. Throughout the project, Bayer Becker attended several meetings with the County to determine their specific project needs and goals. For the project, Bayer Becker completed traffic counts and traffic analysis at the major intersections along Tylersville Road, from I-75 to Cox Road. Based on the results of the analysis, roadway improvement and access management recommendations were made and preliminary concept plans and cost estimates were prepared.

Specifically, Bayer Becker provided preliminary design services for several properties along the Tylersville Road corridor, which consists of private property, mainly retail and office. Bayer Becker's ability to utilize our site experience and incorporate it into the roadway concept plans, when access management was considered and sites adjacent to the roadway corridor were impacted, was a big advantage for the County. The Butler County Engineer's Office recognized Bayer Becker's site development experience along the corridor and throughout the County, in addition to our transportation and roadway design experience. This experience, along with our familiarity of the roadway and traffic conditions in the area, were two elements Bayer Becker brought to the table that other consultants didn't. Our Mason office's close proximity to the project was yet another benefit to the County.

In addition to the planning, engineering, and preliminary design of the project, Bayer Becker incorporated various landscape elements along the corridor where feasible.